

## Installation Instructions

**Thank you** for purchasing TACO Marine Trailer Glyde Slicks. These enable easier launching and retrieval of your watercraft. **Trailer Slicks may not be appropriate if your boat has a hand-riveted aluminum hull, painted hull, non-factory gel coated hull, and/or has been repaired by someone other than a professional.** Since the watercraft slides on the trailer slicks, minor marks might be visible on the bottom of your hull.

### Box Includes

- 6 TRAILER GLYDE SLICKS
- 24 #10 X 1" SERRATED TRUSS HEAD 18-8 GRADE STAINLESS STEEL SCREWS

### Required\* \*not included

- SCREW DRIVER
- MEASURING TAPE

### INSTRUCTIONS

- Strips are to be mounted end to end over your carpeted or uncarpeted bunks.
 

**NOTE: If the bunk wood is rotten, replace it prior to installing the slicks to prevent screw pull-out which will damage your vessel's hull.**
- Use #10 x 1" serrated truss head 18-8 Grade stainless steel screws. These are custom screws and are supplied with the Slicks. Use of these screws and the instructions below prevent the screws from "backing out."
- Each Slick requires 4 of the above screws.
 

**NOTE: Tap each screw hole with a 1/8" drill prior to driving in screws. This will prevent any possible "stripping out" of the phillips head screw heads.**

### PLACEMENT OF SLICKS

- One (1) row in the center of each bunk for PWC and boats UNDER 600 lbs. gross weight.
- Two (2) rows of Slicks side by side (no gap) in the center of each bunk for boats up to 2,000 lbs. gross weight or for wider bunks.

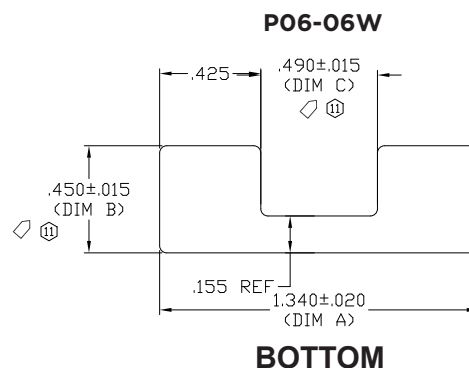
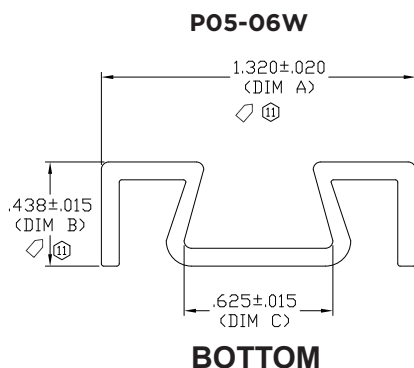

## Important Information

### SPECIFIC MOUNTING INSTRUCTIONS

Firmly tighten the screws so as to slightly “pucker up” the Slick Strip area between the screw.



### DO NOT OVER-TIGHTEN

- This illustration is somewhat exaggerated, but gives you an idea of how to tighten the screws until the strip slightly “squats” under the screw pressure. This will prevent the screw from backing out.
- Start in the back of the trailer, approximately 1” to 1-1/2” forward from the back of each bunk and start installing the Slicks end to end. (End to end and side to side on boats up to 2,000 lbs. gross weight). It is not necessary to cover the whole bunk - only the part that the boat sits on. Remember, it is better to be longer than too short. We strongly recommend that you add an extra length in the very front of your bunks as this is the area that bears most of the weight during stages of boat retrieval. If you have to cut a Slick, cut beyond the nearest hole. Do this only on the front-most Slicks!
- Even though MOST STATES HAVE LAWS requiring you to strap both ends of the boat to the trailer, it is imperative for safety and TO PREVENT DAMAGE TO YOUR BOAT HULL FROM BOUNCING AND MOVING AROUND ON THE SLICKS.

### CAUTION

- Ready to launch when you unhook the boat. We recommend that you leave the hood attached to the bow eye (lifting ring, etc.) and merely release tension on the winch when the back of the watercraft is in the water.
- A Stand clear of the free wheeling crank as the vessel slides down the Slicks and into the water. It is also advisable to have a rope tied to the boat, as it could slide away from you.